

WILDLIFE AND COUNTRYSIDE ACT 1981
COUNTY OF LINCOLN – PARTS OF LINDSEY

FOOTPATH 290 BARNETBY-LE-WOLD
PUBLIC PATH MODIFICATION ORDER

**Wildlife and Countryside Act 1981
County of Lincoln – Parts of Lindsey**

**Footpath No. 290 Barnetby-le-Wold
Public Path Modification Order 2000**

This Order is made by North Lincolnshire Council under Section 53(2)(b) of the Wildlife and Countryside Act 1981 ("The Act") because it appears to that Authority that the Definitive Map and Statement for the County of Lincoln – Parts of Lindsey require modification in consequence of the occurrence of an event specified in Section 53(3)(a)(i), namely, a highway shown or required to be shown on the map and statement has been authorised to be diverted in accordance with the provisions of the Act.

The authority have consulted with every local authority whose area includes the land to which the order relates. The North Lincolnshire Council hereby order that:

1. For the purposes of this order the relevant date is 14 January 2000
2. The Definitive Map and Statement for the County of Lincoln – Parts of Lindsey shall be modified as described in Part I and Part II of the Schedule and shown on the map attached to this order.
3. This order shall take effect on the date it is confirmed and may be cited as the No. 290 Barnetby-le-Wold Public Path Modification order 2000.

SCHEDULE

PART I

**Modification of County of Lincoln – Parts of Lindsey
Description of path or way to be deleted**

Public Footpath 290 in the Parish of Barnetby-le-Wold within the District and County of North Lincolnshire, having a length of approximately 90 metres, commencing at point 'A' on the map contained in this order and proceeding in a westerly direction across the Barnetby le Wold to Market Rasen railway line to point 'C' on map contained in this order.

Description of path or way to be added

A footpath from point A on the map contained in this order running in a generally South-westerly direction for 130 metres to point B on the map, continuing in a generally north westerly direction for approximately 80 metres to point 'C' on the map, crossing the Barnetby le Wold to Market Rasen railway line immediately north of point 'B', on the map contained in this order.

PART II

**Modification of County of Lincoln – Part of Lindsey Statement
Variation of particulars of path or way**

The footpath commences at OS grid reference TA 04590916 and proceeds in a generally south-westerly direction for approximately 130 metres to OS grid reference TA 04530907, changing to a generally north-north-westerly direction for approximately 80 metres, crossing the Barnetby le Wold to Market Rasen railway line at OS grid reference TA 04530908, to OS grid reference TA04500913. The footpath is fenced throughout to a width of approximately 2 metres, except where it crosses the railway line.

The COMMON SEAL of
NORTH LINCOLNSHIRE DISTRICT
COUNCIL was herewith
affixed in the presence of:

J. H. Munn
Authorised Signatory

Seal No. 1705

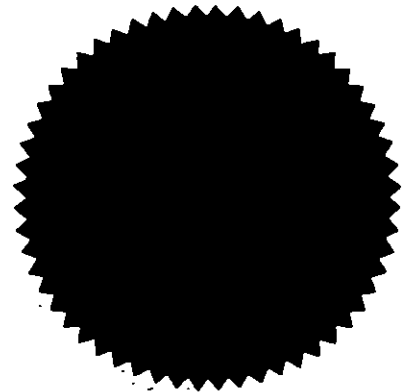

PROPOSED PATH 

EXISTING PATH 

Wreaby Junction

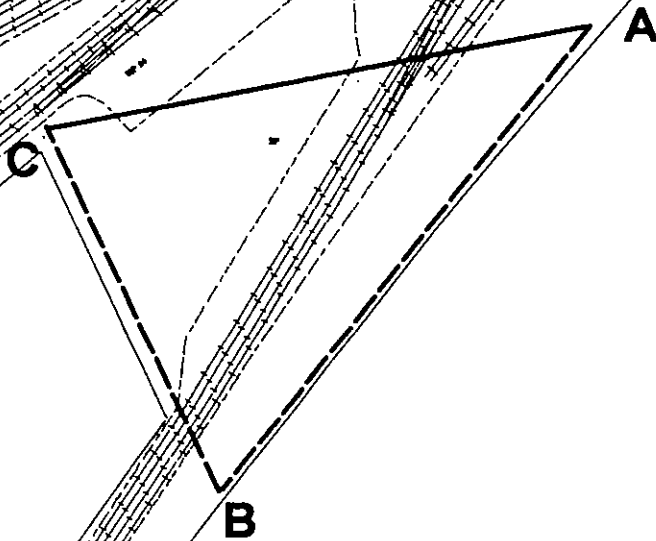

Sand & Gravel Works

J. W. [Signature]

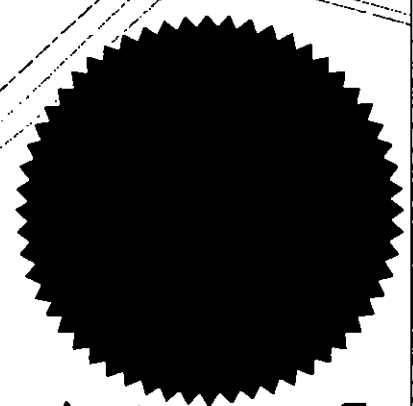

Deal No 1705



North Lincolnshire Council
Directorate of Environment and Public Protection
Church Square House, Scunthorpe

Based on the Ordnance Survey mapping with the permission of the Controller of Her Majesty's Stationery Office © Crown copyright. Unauthorised reproduction infringes Crown copyright and may lead to prosecution or civil proceedings

NORTH LINCOLNSHIRE COUNCIL LA08062L 1999

Title: FP 290 Barnetby Le Wold

Date:

Scale:1:1500

