

WILDLIFE AND COUNTRYSIDE ACT 1981

**DEFINITIVE MAP MODIFICATION
(Public Footpath 127 West Butterwick) ORDER
2005(3)**



**County of Lincoln – Parts of Lindsey
(Isle of Axholme)
Definitive Map and Statement**

Wildlife and Countryside Act 1981

County of Lincoln - Parts of Lindsey (Isle of Axholme) Definitive Map and Statement

Definitive Map Modification (Public Footpath 127 West Butterwick) Order 2005(3)

This order is made by North Lincolnshire Council under section 53(2)(b) of the Wildlife and Countryside Act 1981 ("the Act") because it appears to that authority that the County of Lincoln - Parts of Lindsey (Glanford Brigg) Definitive Map and Statement require modification in consequence of the occurrence of an event specified in section 53(3)(a)(i) - namely, the coming into operation of any enactment or instrument, or any other event, whereby a new right of way has been created over land in the area to which the map relates, being a right of way such that the land over which the right subsists is a public path - of the Act.

The authority have consulted every local authority whose area includes the land to which the order relates. North Lincolnshire Council hereby order that:

1. For the purposes of this order the relevant date is 28th October 2005.
2. The County of Lincoln - Parts of Lindsey (Isle of Axholme) Definitive Map and Statement shall be modified as described in the Schedule and shown on the map attached to the order.
3. This order shall take effect on the date it is made and may be cited as the Definitive Map Modification (Public Footpath 127 West Butterwick) Order 2005(3).

SCHEDULE

PART 1

Modification of County of Lincoln Parts of Lindsey (Isle of Axholme) Definitive Map

Description of path to be deleted

A – B as indicated on the map: A 134-metre-long footpath commencing approximately 120 metres west of its junction with North Street at grid reference SE8346205997, proceeding first in a south-westerly direction for 50 metres to a point on the eastern side of School Lane at grid reference

SE8342305968, then in a westerly direction for 84 metres to a point on the eastern side of O.S. Field number 1695 at grid reference SE8333905963.

**THE COMMON SEAL of
NORTH LINCOLNSHIRE COUNCIL**

Was hereto affixed
In the presence of:

M Wood
(authorised signatory)

Seal No: *4836*

Dated: *9th November 2005*



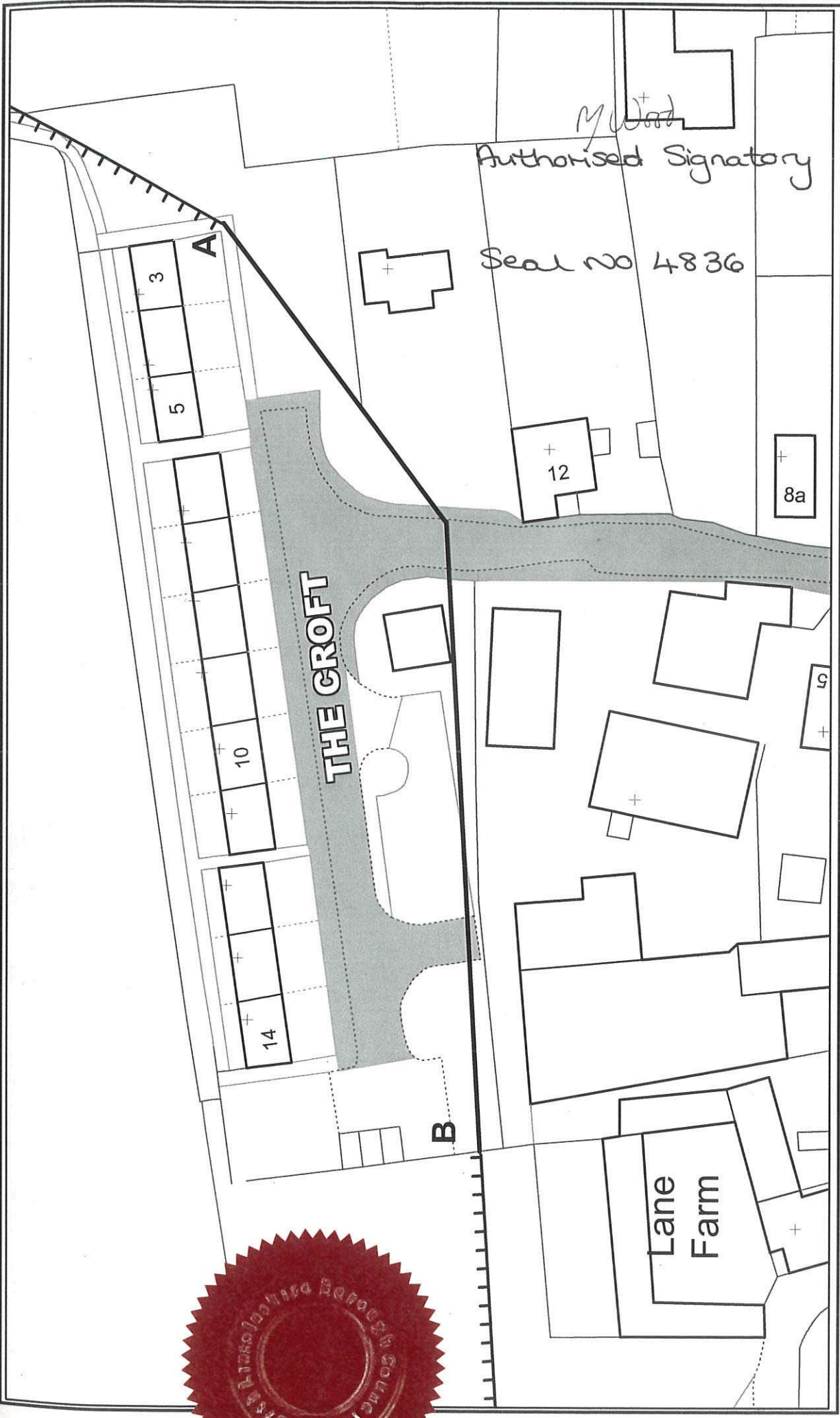

 <p>Planning and Regeneration Service Head of Service, T Lyman BSc(Hons), DipTP, MRTPI</p>	Drawing Title: West Butterwick FP127	
	Drawn by: AG	Date: 08.07.05
Based upon the Ordnance Survey mapping with the permission of Ordnance Survey on behalf of the Controller of Her Majesty's Stationary Office © Crown Copyright. Unauthorised reproduction infringes Crown Copyright and may lead to prosecution or civil proceedings. NORTH LINCOLNSHIRE COUNCIL 100013349 2005		
The Ordnance Survey map data included within this publication is provided by North Lincolnshire Council under license from Ordnance Survey in order to fulfil its public function to act as a planning authority. Persons viewing this mapping should contact Ordnance Survey copyright for advice where they wish to license Ordnance Survey map data for their own use.		