

Wildlife and Countryside Act 1981

County of Lincoln – Parts of Lindsey (Glanford Brigg) Definitive Map and Statement

Definitive Map Modification (Public Footpath 32, Barton) Order 2005(2)

The order is made by North Lincolnshire Council under section 14(2)(B) of the Wildlife and Countryside Act 1981 (the Act) in exercise of powers conferred on that authority by the County of Lincoln – Parts of Lindsey (The New Brigg) Definitive Map and Statement (Public Footpath 32, Barton) Order 2005(2) in consequence of the approval of that order by the Secretary of State for the Environment, Heritage and Local Government.

## WILDLIFE AND COUNTRYSIDE ACT 1981

### DEFINITIVE MAP MODIFICATION (Public Footpath 32, Barton) ORDER 2005(2)

The authority has exercised its powers under section 14(2)(B) of the Wildlife and Countryside Act 1981 to make this order in consequence of the approval of that order by the Secretary of State for the Environment, Heritage and Local Government.

For the purposes of this order the relevant date is 2<sup>nd</sup> May 2005.

The County of Lincoln (Parts of Lindsey) (Glanford Brigg) Definitive Map and Statement (Public Footpath 32, Barton) Order 2005(2) is set out in Part 1 and Part 2 of the Schedule and amended accordingly.

This order shall be published in the Local Government Gazette and may be cited as the Definitive Map Modification Order 2005(2).



County of Lincoln – Parts of Lindsey (Glanford Brigg)  
Definitive Map and Statement

The order is made by North Lincolnshire Council under section 14(2)(B) of the Wildlife and Countryside Act 1981 (the Act) in exercise of powers conferred on that authority by the County of Lincoln – Parts of Lindsey (The New Brigg) Definitive Map and Statement (Public Footpath 32, Barton) Order 2005(2) in consequence of the approval of that order by the Secretary of State for the Environment, Heritage and Local Government.

**Wildlife and Countryside Act 1981**

**County of Lincoln – Parts of Lindsey (Glanford Brigg) Definitive Map and Statement**

**Definitive Map Modification (Public Footpath 32, Barton) Order 2005(2)**

This order is made by North Lincolnshire Council under section 53(2)(b) of the Wildlife and Countryside Act 1981 ("the Act") because it appears to that authority that the County of Lincoln – Parts of Lindsey (Glanford Brigg) Definitive Map and Statement require modification in consequence of the occurrence of an event specified in section 53(3)(a)(i) – namely, the coming into operation of any enactment or instrument, or any other event, whereby a highway shown or required to be shown in the map or statement has been authorised to be stopped up, diverted, widened or extended – of the Act.

The authority have consulted every local authority whose area includes the land to which the order relates. North Lincolnshire Council hereby order that:

1. For the purposes of this order the relevant date is 3<sup>rd</sup> May 2005.
2. The County of Lincoln – Parts of Lindsey (Glanford Brigg) Definitive Map and Statement shall be modified as described in Part 1 and Part 2 of the Schedule and shown on the map attached to the order.
3. This order shall take effect on the date it is made and may be cited as the Definitive Map Modification (Public Footpath 32, Barton) Order 2005(2).

**SCHEDULE**

**PART 1**

**Modification of Parts of Lindsey (Glanford Brigg) Definitive Map**

**Description of path to be deleted**

*A – B as indicated on the map:* A 405-metre-long footpath commencing on the existing footpath on the south bank of the River Humber at grid reference TA0184323380, proceeding along an access track between O.S. Field number 6300 and O.S. Field numbers 8800 and 9224 on the east in a southerly direction to its junction with the unclassified public highway known as Far Ings Lane at grid reference TA0183822978.



Description of path to be added

A – B as indicated on the map: a 195-metre-long footpath with a width of 1.80 metres commencing on the existing footpath some 210 metres west of the junction with Waterside Road at grid reference TA0259023411, proceeding beneath the Humber Bridge along the south bank of the River Humber in a westerly direction to a point on the existing footpath at grid reference TA0239023406.

PART 2

Modification of Parts of Lindsey (Glanford Brigg) Definitive Statement

Variation of particulars of path

A 195-metre-long footpath with a width of 1.80 metres commencing on the existing footpath some 210 metres west of the junction with Waterside Road at grid reference TA0259023411, proceeding beneath the Humber Bridge along the south bank of the River Humber in a westerly direction to a point on the existing footpath at grid reference TA0239023406.

THE COMMON SEAL of  
NORTH LINCOLNSHIRE COUNCIL

Was hereto affixed  
In the presence of:

*M Wood*

(Authorised signatory)

Seal No.: 4631

Dated:

26th May 2005



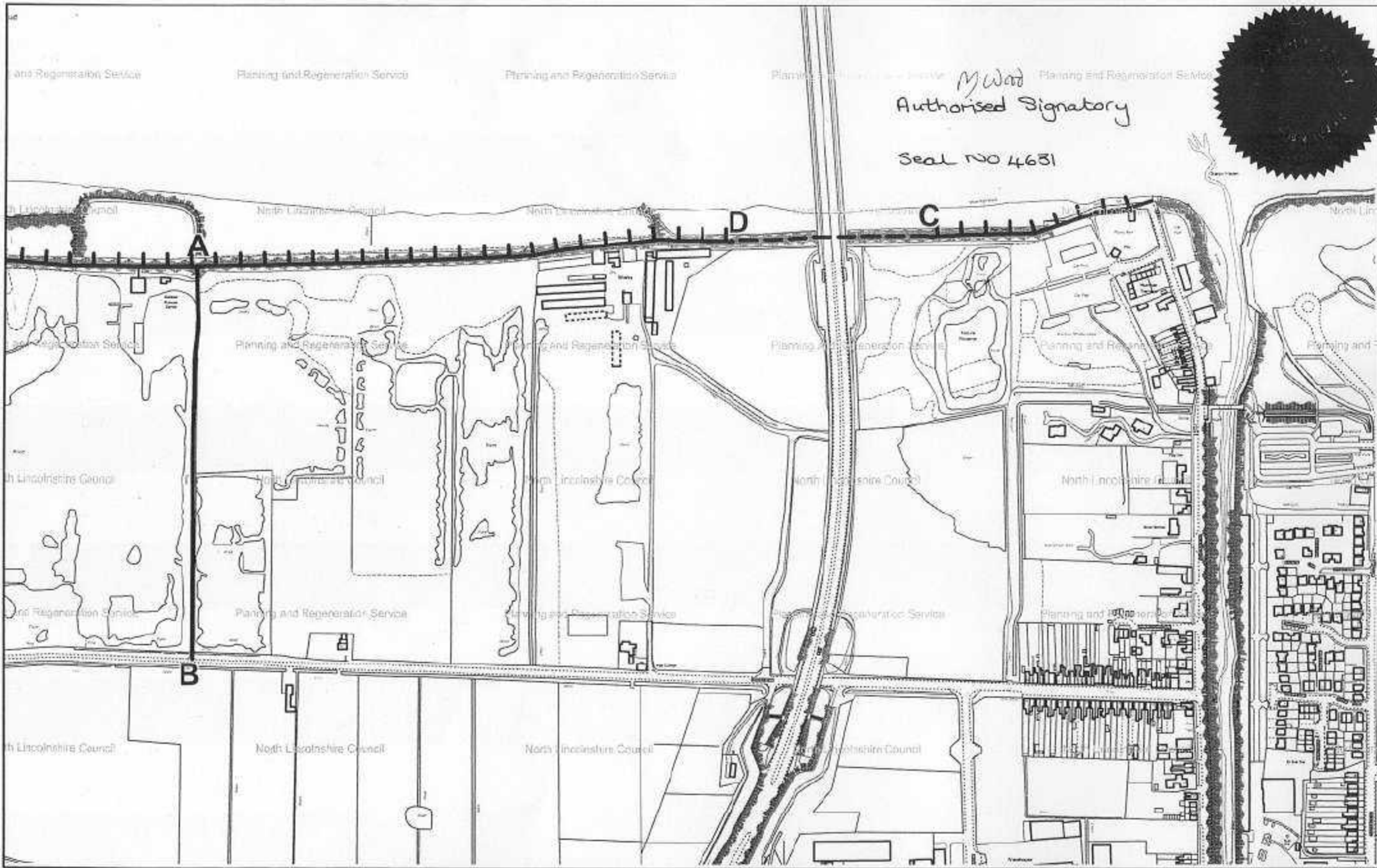

Based upon the Ordnance Survey mapping with the permission of  
Ordnance Survey on behalf of the Controller of Her Majesty's Stationary Office.  
© Crown Copyright.  
Unauthorised reproduction infringes Crown Copyright  
and may lead to prosecution or civil proceedings.  
NORTH LINCOLNSHIRE COUNCIL 100013345 2005

The Ordnance Survey map data included within this publication is provided by North Lincolnshire Council under license from Ordnance Survey in order to fulfil its public function to act as a planning authority. Persons viewing this mapping should contact Ordnance Survey copyright for advice where they wish to license Ordnance Survey map data for their own use.

Drawing Title: Barton-upon-Humber 32(2)

Drawn by: TT

Scale: 1:3500

Date: 05/05/2005



Planning and Regeneration Service  
Head of Service  
T Lyman BSc(Hons), DipT, MRTP