

**WILDLIFE AND COUNTRYSIDE ACT 1981**

**DEFINITIVE MAP MODIFICATION (Public Footpath  
Worlaby, 141) Order 2005(2)**



**County of Lincoln – Parts of Lindsey (Glanford Brigg)  
Definitive Map and Statement**

## Wildlife and Countryside Act 1981

### County of Lincoln – Parts of Lindsey (Glanford Brigg) Definitive Map and Statement

#### Definitive Map Modification (Public Footpath 141, Worlaby) Order 2005(2)

This order is made by North Lincolnshire Council under section 53(2)(b) of the Wildlife and Countryside Act 1981 ("the Act") because it appears to that authority that the County of Lincoln – Parts of Lindsey (Glanford Brigg) Definitive Map and Statement require modification in consequence of the occurrence of an event specified in section 53(3)(a)(i) – namely, the coming into operation of any enactment or instrument, or any other event, whereby a highway shown or required to be shown in the map or statement has been authorised to be stopped up, diverted, widened or extended – of the Act.

The authority have consulted every local authority whose area includes the land to which the order relates. North Lincolnshire Council hereby order that:

1. For the purposes of this order the relevant date is 25 February 2005.
2. The County of Lincoln – Parts of Lindsey (Glanford Brigg) Definitive Map and Statement shall be modified as described in Part 1 and Part 2 of the Schedule and shown on the map attached to the order.
3. This order shall take effect on the date it is made and may be cited as the Definitive Map Modification (Public Footpath 141, Worlaby) Order 2005(2).

### SCHEDULE

#### PART 1

##### Modification of Parts of Lindsey (Glanford Brigg) Definitive Map

##### *Description of path to be deleted*

*A – B as indicated on the map:* A 66-metre-long footpath commencing at grid reference TA0129113839 on the existing footpath proceeding in a north-north-westerly direction to the junction with New Road at grid reference TA0125813898.



*Description of path to be added*

A – C as indicated on the map: A 60-metre-long footpath with a width of 1.8 metres commencing at grid reference TA0129113839 on the existing footpath proceeding in a north-westerly direction to the junction with New Road at a point 28 metres south-west from the original point at grid reference TA0124213877.

PART 2

Modification of Parts of Lindsey (Glanford Brigg) Definitive Statement

*Variation of particulars of path*

A 60-metre-long footpath with a width of 1.8 metres commencing on the existing footpath at the northern side of a boundary fence of a property known as No.58 Low Road at grid reference TA0129113839 proceeding along the western side of a boundary fence of a property known as No19 New Road and the eastern side of a boundary fence of a property known as No 21 New Road in a north-westerly direction to the junction with New Road at a point 28 metres south-west from the original point at grid reference TA0124213877.

THE COMMON SEAL of  
NORTH LINCOLNSHIRE COUNCIL

Was hereto affixed

In the presence of:

  
(Authorised signatory)

Seal No.: 4518

Dated: 4th March 2005





*W. Wells*  
Authorised Signatory

Seal No 4518

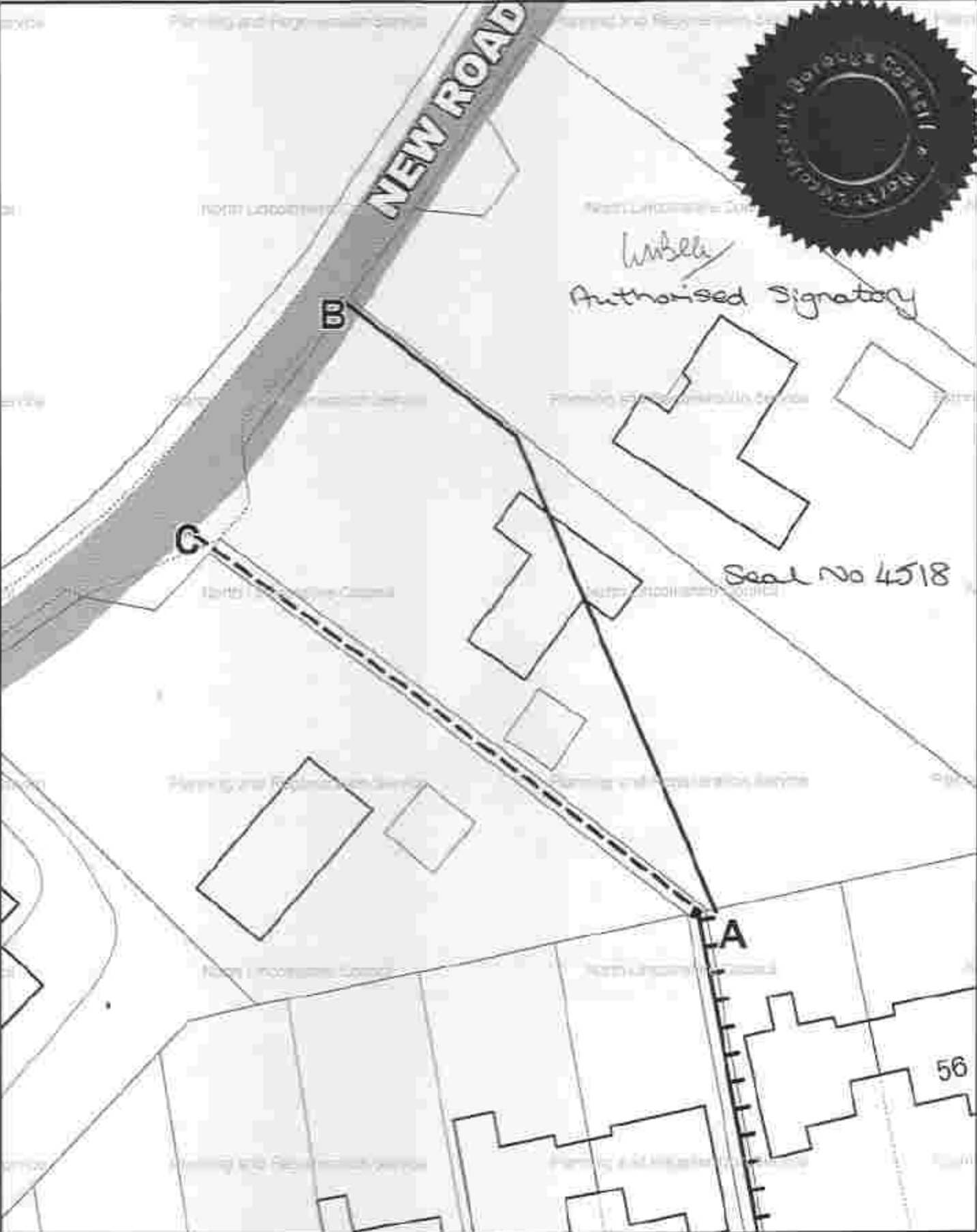

Drawing Title: Woraby 141 2005 (2)      Drawn by: TT      Scale: 1:500      Date: 23/02/2005



Based upon the Ordnance Survey mapping with the permission of  
Ordnance Survey on behalf of the Controller of the Majesty's Stationery Office  
© Crown Copyright  
Unauthorised reproduction is illegal. Crown Copyright  
and may lead to prosecution or civil proceedings.  
NORTH LINCOLNSHIRE COUNCIL, 130013349 2005



Planning and  
Regeneration Service  
Head of Service,  
T Lyman BSc (Hons), DipP, MRP

The Ordnance Survey map data included within this publication is provided by North Lincolnshire Councils under license from Ordnance Survey in order to fulfil its public function to act as a planning authority. Persons viewing this mapping should contact Ordnance Survey's copyright for advice where they wish to license Ordnance Survey map data for their own use.